

9 8 7 6 5 4 3 2 1

G
F
E
D
C
B
A

G
F
E
D
C
B
A

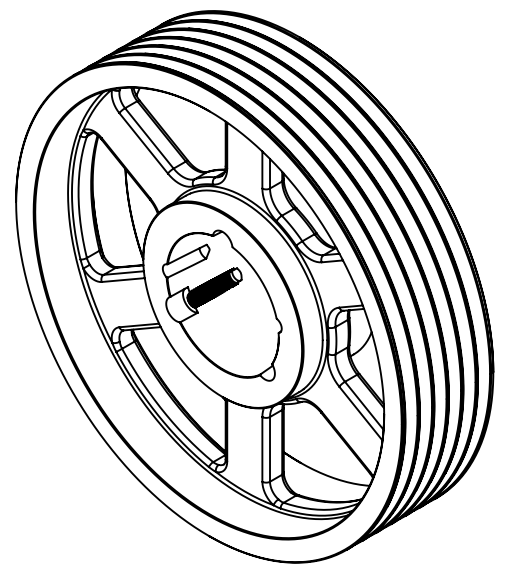
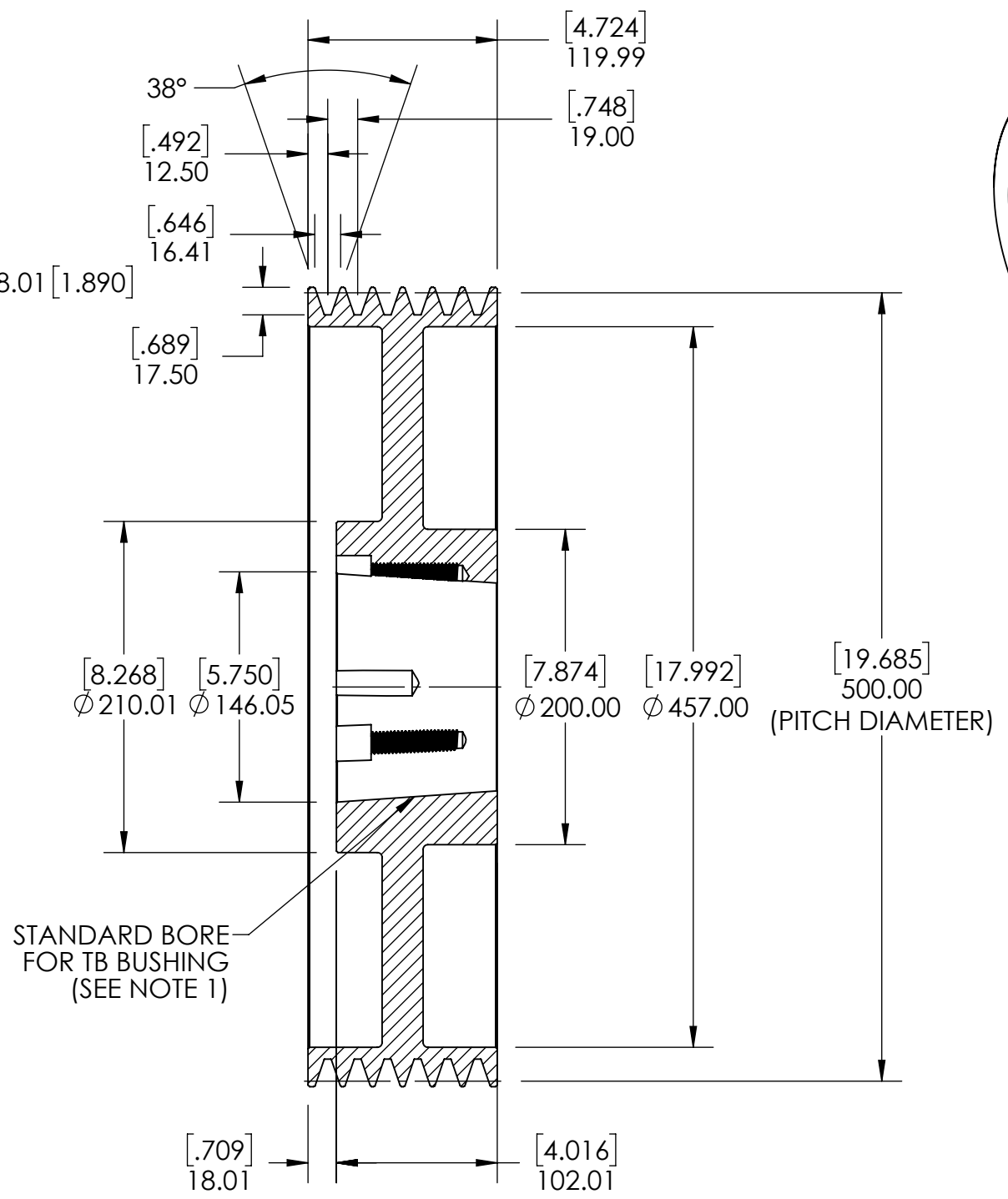
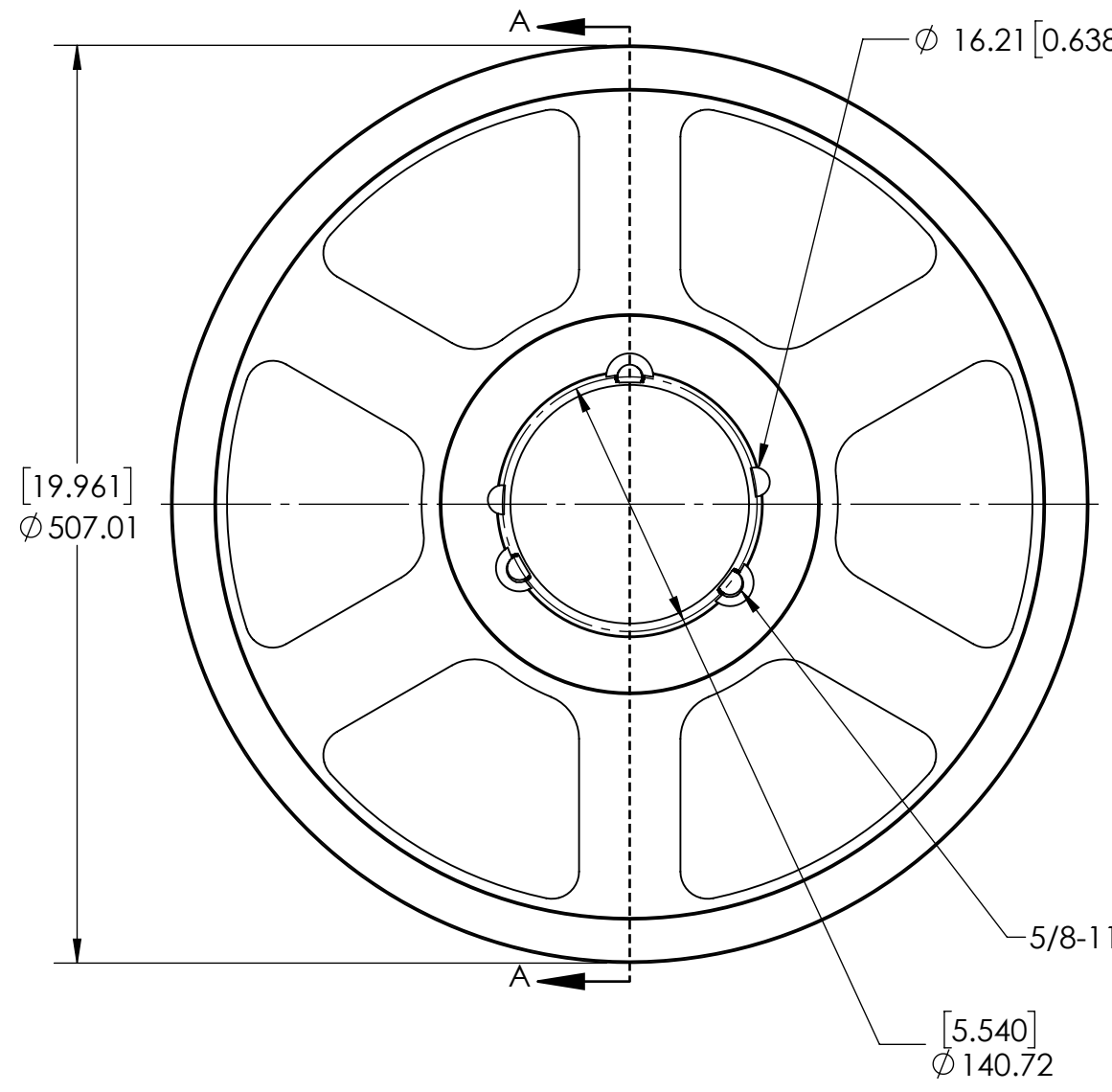

STANDARD BORE FOR TB BUSHING (SEE NOTE 1)

SECTION A-A

NOTES:
1. TB BUSHING SIZE: 4040
2. UNITS: mm [INCHES].

SOLVE INDUSTRIAL MOTION GROUP		WEIGHT	43.26 KG				
		MATERIAL	CAST IRON				
		COATING	GREY PAINT				
		DRAWN	MTC	09/02/2025			
		CHECKED					
		APPROVED			DATE	BY	REVISION DESCRIPTION
SIZE	B						
		DWG. NO.		ITEM DESCRIPTION:		REV	
		PTI		SPB500X6-4040		1:4	
		PROPRIETARY AND CONFIDENTIAL				-	
		THE INFORMATION CONTAINED IN THIS DRAWING IS THE SOLE PROPERTY OF SOLVE IMG. ANY REPRODUCTION IN PART OR AS A WHOLE WITHOUT THE WRITTEN PERMISSION OF SOLVE IMG IS PROHIBITED.					

9 8 7 6 5 4 3 2 1