

Extra-thin-section bearings [Stainless-steel]

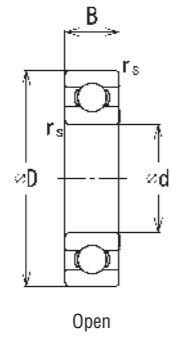

Open

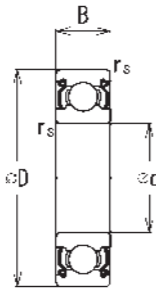

Shielded: ZZ



Sealed: 2RS



Sealed: 2RU



Sealed: TTS

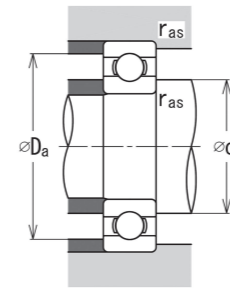

Abutment and fillet

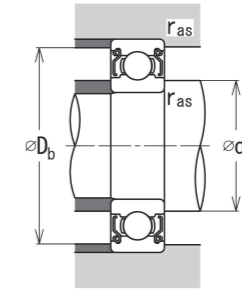

Dimension

Extra-thin-section bearings [Stainless-steel]

Bore diameter d		Outer diameter D		Width				Chamfer r _s (min)		Bearing number					Load rating		Limiting speed ⁽³⁾	
				Open B		Shielded, Sealed B ₁				Open	2 Shields ⁽²⁾	2 Seals ⁽²⁾			Cr	Cor	Grease	Oil
mm	inch	mm	inch	mm	inch	mm	inch	mm	inch	Open	2 Shields ⁽²⁾	2RS	2RU	TTS	N		min ⁻¹	
10	0.3937	15	0.5906	3	0.1181	4	0.1575	0.15	0.0059	6700H	6700HZZ	2RS	—	—	729	348	15 000	17 000
		19	0.7480	5	0.1969	5	0.1969	0.30	0.0118	6800H⁽¹⁾	6800HZZ	2RS	2RU	—	1 460	672	34 000	40 000
		19	0.7480	7	0.2756	7	0.2756	0.30	0.0118	63800H⁽¹⁾	63800HZZ	2RS	2RU	—	1 460	672	34 000	40 000
12	0.4724	22	0.8661	6	0.2362	6	0.2362	0.30	0.0118	6900H⁽¹⁾	6900HZZ	2RS	2RU	—	2 290	1 020	31 000	37 000
		18	0.7087	4	0.1575	4	0.1575	0.20	0.0079	6701H⁽¹⁾	6701HZZ	2RS	—	—	789	425	13 000	15 000
		21	0.8268	5	0.1969	5	0.1969	0.30	0.0118	6801H⁽¹⁾	6801HZZ	2RS	2RU	—	1 630	834	30 000	36 000
		21	0.8268	7	0.2756	7	0.2756	0.30	0.0118	63801H⁽¹⁾	63801HZZ	2RS	2RU	—	1 630	834	30 000	36 000
15	0.5906	24	0.9449	6	0.2362	6	0.2362	0.30	0.0118	6901H⁽¹⁾	6901HZZ	2RS	2RU	—	2 460	1 170	28 000	33 000
		21	0.8268	4	0.1575	4	0.1575	0.20	0.0079	6702H⁽¹⁾	6702HZZ	2RS	—	—	797	465	11 000	13 000
		24	0.9449	5	0.1969	5	0.1969	0.30	0.0118	6802H⁽¹⁾	6802HZZ	2RS	2RU	—	1 760	1 010	26 000	31 000
		24	0.9449	7	0.2756	7	0.2756	0.30	0.0118	63802H⁽¹⁾	63802HZZ	2RS	2RU	—	1 760	1 010	26 000	31 000
17	0.6693	28	1.1024	7	0.2756	7	0.2756	0.30	0.0118	6902H⁽¹⁾	6902HZZ	2RS	2RU	—	3 680	1 800	24 000	29 000
		23	0.9055	4	0.1575	4	0.1575	0.20	0.0079	6703H⁽¹⁾	6703HZZ	2RS	—	—	849	525	9 500	11 000
		26	1.0236	5	0.1969	5	0.1969	0.30	0.0118	6803H⁽¹⁾	6803HZZ	2RS	2RU	—	1 900	1 170	24 000	29 000
		30	1.1811	7	0.2756	7	0.2756	0.30	0.0118	6903H⁽¹⁾	6903HZZ	2RS	2RU	—	3 900	2 050	22 000	26 000
20	0.7874	27	1.0630	4	0.1575	4	0.1575	0.20	0.0079	6704H⁽¹⁾	6704HZZ	2RS	—	—	885	583	8 500	10 000
		32	1.2598	7	0.2756	7	0.2756	0.30	0.0118	6804H⁽¹⁾	6804HZZ	2RS	2RU	—	3 410	1 970	21 000	25 000
		37	1.4567	9	0.3543	9	0.3543	0.30	0.0118	6904H⁽¹⁾	6904HZZ	2RS	2RU	—	5 420	2 950	19 000	22 000
25	0.9843	32	1.2598	4	0.1575	4	0.1575	0.20	0.0079	6705H⁽¹⁾	6705HZZ	2RS	2RU	—	931	670	7 000	8 000
		37	1.4567	7	0.2756	7	0.2756	0.30	0.0118	6805H⁽¹⁾	6805HZZ	2RS	2RU	—	3 660	2 350	18 000	21 000
		42	1.6535	9	0.3543	9	0.3543	0.30	0.0118	6905H⁽¹⁾	6905HZZ	2RS	2RU	—	5 960	3 640	16 000	19 000
30	1.1811	37	1.4567	4	0.1575	4	0.1575	0.20	0.0079	6706H⁽¹⁾	6706HZZ	2RS	2RU	—	969	757	5 500	7 000
		42	1.6535	7	0.2756	7	0.2756	0.30	0.0118	6806H⁽¹⁾	6806HZZ	2RS	2RU	—	3 860	2 730	15 000	18 000
		47	1.8504	9	0.3543	9	0.3543	0.30	0.0118	6906H⁽¹⁾	6906HZZ	2RS	2RU	—	6 160	4 010	14 000	17 000
35	1.3780	44	1.7323	5	0.1969	5	0.1969	0.30	0.0118	6707H⁽¹⁾	—	2RS	—	—	1 590	1 310	4 900	6 000
		47	1.8504	7	0.2756	7	0.2756	0.30	0.0118	6807H⁽¹⁾	6807HZZ	2RS	2RU	—	4 030	3 060	13 000	16 000
		55	2.1654	10	0.3937	10	0.3937	0.60	0.0236	6907H⁽¹⁾	6907HZZ	2RS	2RU	—	9 250	6 200	12 000	14 000
40	1.5748	50	1.9685	6	0.2362	6	0.2362	0.30	0.0118	6708H⁽¹⁾	—	2RS	—	—	2 140	1 790	4 300	5 000
		52	2.0472	7	0.2756	7	0.2756	0.30	0.0118	6808H⁽¹⁾	6808HZZ	2RS	2RU	—	4 190	3 340	12 000	14 000
		62	2.4409	12	0.4724	12	0.4724	0.60	0.0236	6908H⁽¹⁾	6908HZZ	2RS	2RU	—	11 600	7 930	11 000	13 000
45	1.7717	58	2.2835	7	0.2756	7	0.2756	0.30	0.0118	6809H⁽¹⁾	6809HZZ	2RS	2RU	—	5 280	4 300	11 000	13 000
		68	2.6772	12	0.4724	12	0.4724	0.60	0.0236	6909H⁽¹⁾	6909HZZ	2RS	2RU	—	12 000	8 700	9 700	11 000
50	1.9685	65	2.5591	7	0.2756	7	0.2756	0.30	0.0118	6810H⁽¹⁾	6810HZZ	2RS	2RU	—	5 440	4 660	9 500	11 000
		72	2.8346	12	0.4724	12	0.4724	0.60	0.0236	6910H⁽¹⁾	6910HZZ	2RS	2RU	—	12 400	9 370	9 000	11 000
55	2.1654	72	2.8346	9	0.3543	9	0.3543	0.30	0.0118	6811H⁽¹⁾	6811HZZ	2RS	2RU	—	7 480	6 470	8 600	10 000
		80	3.1496	13	0.5118	13	0.5118	1.00	0.0394	6911H⁽¹⁾	6911HZZ	2RS	2RU	—	14 100	11 300	8 100	9 600

(1) Open bearings have shield/seal grooves.
 (2) Single-shielded/single-sealed bearings are also available; suffix Z, RS, RU or TS.
 (3) Applicable only for open, single Z, ZZ, single RU and 2RU types in inner ring rotating conditions.
 Limiting speeds for the contact rubber seal(s) types can be lower than the above-mentioned values, so please check the detailed values per item on "products" section of our website.
 (4) Some items are also available with the TW cage. Please contact us for details.

Cage type ⁽⁴⁾	Ball		Abutment and fillet dimensions							Mass (Ref.)	
			Open		Shielded, Sealed		r _{as} (max)	Open	2 Shields		
	Size	Qty.	d _a (min)	d _a (max)	D _a (min)	D _a (max)				D _b (min)	D _b (max)
	mm	pcs.	mm		mm		mm		mm		
W	1.588	11	11.00	11.00	14.00	14.50	14.50	14.50	0.15	1.33	1.74
J	2.381	10	11.50	11.50	17.50	17.50	17.50	17.50	0.30	4.76	5.04
J	2.381	10	11.50	11.50	17.50	17.50	17.50	17.50	0.30	6.67	6.95
J	3.175	9	12.00	13.00	19.50	20.00	19.50	20.00	0.30	8.69	9.28
W	1.588	13	13.50	13.50	17.00	17.00	17.00	17.00	0.20	2.62	2.80
J	2.381	12	13.50	13.50	19.50	19.50	19.50	19.50	0.30	5.29	5.64
J	2.381	12	13.50	13.50	19.50	19.50	19.50	19.50	0.30	7.49	7.84
J	3.175	10	14.00	15.00	21.50	22.00	21.50	22.00	0.30	9.84	10.7
W	1.588	14	16.50	16.50	20.00	20.00	20.00	20.00	0.20	3.13	3.34
J	2.381	14	16.50	16.50	22.50	22.50	22.50	22.50	0.30	6.20	6.61
J	2.381	14	16.50	16.50	22.50	22.50	22.50	22.50	0.30	8.81	9.22
J	3.969	10	17.00	18.50	25.50	26.00	25.50	26.00	0.30	14.7	15.8
W	1.588	16	18.50	18.50	22.00	22.00	22.00	22.00	0.20	3.48	3.71
J	2.381	16	18.50	18.50	24.50	24.50	24.50	24.50	0.30	7.01	7.46
J	3.969	11	19.00	20.50	28.00	28.50	28.00	28.50	0.30	15.4	16.6
W	1.588	18	21.50	22.00	26.00	26.00	26.00	26.00	0.20	5.03	5.34
J	3.500	13	22.00	22.50	30.00	30.50	30.00	30.50	0.30	15.6	16.9
RJ	4.762	11	22.00	23.50	34.00	35.00	34.00	35.00	0.30	32.6	34.7
W	1.588	21	26.50	27.00	31.00	31.00	31.00	31.00	0.20	6.08	6.46
J	3.500	15	27.00	28.00	34.50	35.00	34.50	35.00	0.30	19.4	20.6
RJ	4.762	13	27.00	30.50	39.50	40.00	39.50	40.00	0.30	38.7	41.5
W	1.588	24	31.50	32.00	36.00	36.00	36.00	36.00	0.20	7.26	7.69
J	3.500	17	32.00	33.00	39.50	40.00	39.50	40.00	0.30	21.9	23.1
RJ	4.762	14	32.00	35.00	44.50	45.00	44.50	45.00	0.30	43.4	47.4